

THE MOUNTAIN PLAYHOUSE ~ LIVE PROFESSIONAL THEATRE AND SOOO MUCH MORE!

Day 1: Meet local guide at time and location to be decided. If group arrives before Noon a lunch location will be chosen. If arriving after Noon please plan on lunch prior to arrival.

Afternoon - Evening:

- At the Lincoln Highway Heritage Museum you see an award-winning film on historic Route 30, the Lincoln Highway, various gas pumps from yesteryear (anyone remember \$.18 per gallon?) and many more artifacts/photos. Brand new this year is nostalgic Serro's Diner and an early tourist cabin, both from the Lincoln Highway in this area. While visiting the diner you are served pie and a beverage.
- At Fort Ligonier you journey back to the 18th century and the time of the French and Indian War. The remarkable museum exhibits include "The World Ablaze: An Introduction to the Seven Years' War, featuring over 200 original objects from around the world including a rare, original Redcoat Uniform. You see a pair of George Washington's saddle pistols and catch a glimpse of his memoirs, "Remarks," in his own handwriting. The fort itself has been accurately re-created.
- Lodging is at the award-winning Comfort Inn or Hampton Inn of Somerset.
- Following check in and a brief break you depart for nearby Green Gables Restaurant for dinner followed by a short stroll across beautifully landscaped grounds to the Mountain Playhouse and this evening's live production.



Please see the playhouse schedule on the next page.

Day 2: Following breakfast and check out you depart with your local guide for a day of Remembrance. NOTE: if you/your group has been to Flight 93 in the past you may choose other activities for the day...many options, take a look at other tours in this book or discuss with Carol Love, tour planner for Love Receptive Services.

Today:

- Pay your respects at the Flight 93 National Memorial. If your tour comes after 9/11/18 your guests should be able to view and listen to the Tower of Voices, a 93 foot tall tower with 40 large wind chimes, each singing out a different tone, hence the Tower of the Voices of Flight 93. Also visit the indoor Visitor Center with many touching exhibits regarding 9/11 and Flight 93. At the Memorial Plaza you will come as close as possible to the crash site and you walk to the Memorial Wall, featuring the names of the 40 Heroes of Flight 93. Each tour member receives a commemorative magnet "Remember the Heroes of Flight 93".
- At the Flight 93 Memorial Chapel you see a Monument "Forever in Our Hearts" dedicated to the memory of the Flight Crew by United Airlines Flight Attendants. Indoors there are many items and stories that will touch your hearts.

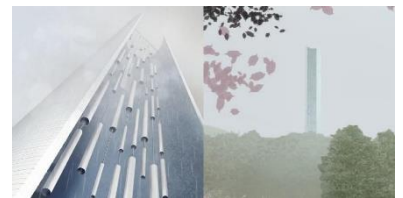

- Lunch at one of the area’s restaurants featuring delicious food and friendly atmosphere.
- Do you remember July 2002 when 9 miners were trapped in a flooding mine 240 feet beneath a farmer’s field in Somerset County? Today you visit the Rescue Site, see the shaft through which each man traveled in the rescue capsule to return to families and friends and see the rescue capsule itself! In a comfortable visitor center you hear the miraculous story of the rescue.



Approx. 3:30 PM depart for home.

NOTE: timing and stops can be adjusted based on your schedule.

PRICE INCLUDES: 1 night lodging, 1 breakfast, 1 lunch, 1 dinner, live theatre production, tours and admissions as listed, baggage handling, step on guide throughout, taxes and gratuities on included items. NOT included: guide gratuity

PRICE PER PERSON:

TWIN	TRIPLE	QUAD	SINGLE	
\$188	\$178	\$171	\$223	Comfort Inn Somerset
\$208	\$192	\$185	\$257	Hampton Inn Somerset

Mountain Playhouse 2018 Season

June 19-July 1	<i>Life Could Be a Dream</i>	Musical
July 10-29	<i>Million Dollar Quartet</i>	Musical
July 31-August 12	<i>Who’s Under Wear</i>	Farce
Aug 14-26	<i>The Affections of May</i>	Comedy
Sept 18-30	<i>One Slight Hitch</i>	Comedy
Oct 2-14	<i>Smoke on the Mountain</i>	Musical



NOTE: 2019 marks the 130th Anniversary of the Johnstown Flood and the 80th Birthday of the Mountain Playhouse. In honor of these two events Love Receptive Services is pleased to offer a special two-day outing featuring various locations in Johnstown along with *The Johnstown Flood* production at The Mountain Playhouse. Dates to be September 2019. Please email or call Love Receptive Services for a detailed itinerary OR for one to be customized for you.